

DIMM

INSTALLATION GUIDE

Preparation

For safe operation, see "Safety Information", *Setup Guide*.

CAUTION:

- Do not touch the inside of the controller board compartment. It may cause a machine malfunction or a burn.

Important

- ☐ Before touching the DIMM, touch something metal to discharge any static electricity. Static electricity can damage the DIMM.

Installing the DIMM

1 Turn off the power.

2 Unplug the power cord, and then disconnect the interface cable.

Note

- ☐ If the Duplex Unit is not attached, proceed to step **4**.

3 If the Duplex Unit is attached, push down the release button on the right side (①) and pull out the Duplex Unit until it stops (②).

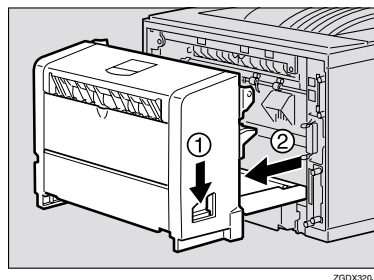

4 Remove the two screws using a coin.

Note

- ☐ The removed screws are required in step **11**.

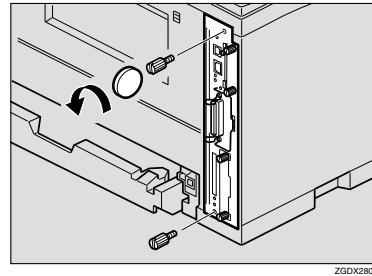

5 Pull out the handle of the controller board.

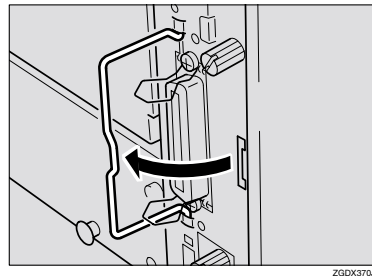

6 Pull the handle and slide the controller board out.

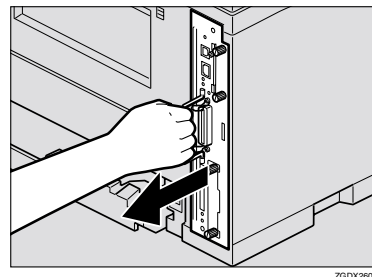

- 7** Place the controller board on a flat surface.

- 8** Insert the DIMM into the slot, and push it down until it clicks. If the DIMM is not set in the correct way, it does not click.

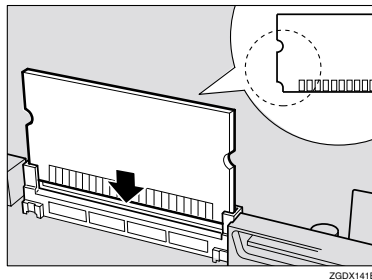

- 9** Align the controller board to the top and bottom rail using the "▼" mark, and then slide it into the printer slowly until it stops.

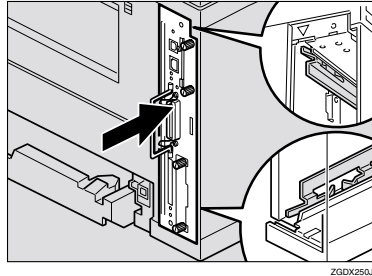

- 10** Push the handle of the controller board down until it clicks.

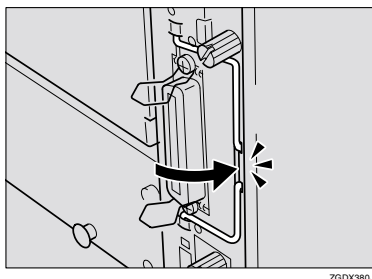

- 11** Fasten the controller board to the printer with the two screws.

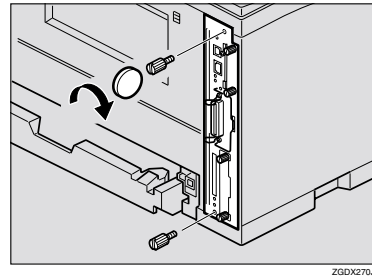

Note

- ☐ If the Duplex Unit is not attached, proceed to step 13.

- 12** While aligning the power cord to the left side groove of the Duplex Unit, slide the Duplex Unit in until it is connected to the printer.

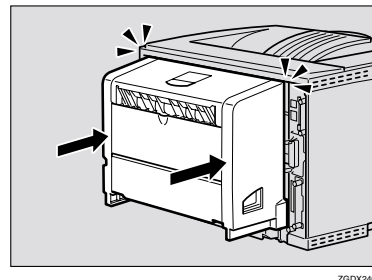

- 13** Attach the interface cable, and then plug in the power cord.

- 14** Turn on the power.

Note

- ☐ After finishing installation, print the configuration page from the "List/Test Print Menu" to confirm that the DIMM is installed properly. See "List/Test Print Menu", *Printer Reference*, on the CD-ROM labeled "Operating Instructions".